

## GT 65/2/173 C. 175-180

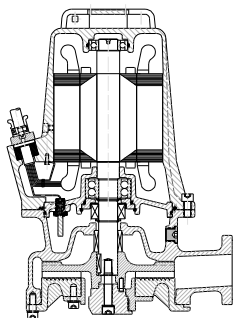

Su richiesta  
On request  
Sur requête



GIRANTE CON TRITURATORE  
IMPELLER FOR GRINDER  
ROUE POUR SECATRICE



PASSAGGIO LIBERO	10mm
FREE PASSAGE	10mm
SECTION DE PASSAGE	10mm

ALBERO MOTORE	AISI 420
MOTOR SHAFT	AISI 420
ARBRE MOTEUR	AISI 420

Curve secondo ISO 9906. Livello 2  
Curves as per ISO 9906. Grade 2  
Courbes selon ISO 9906. Niveau 2

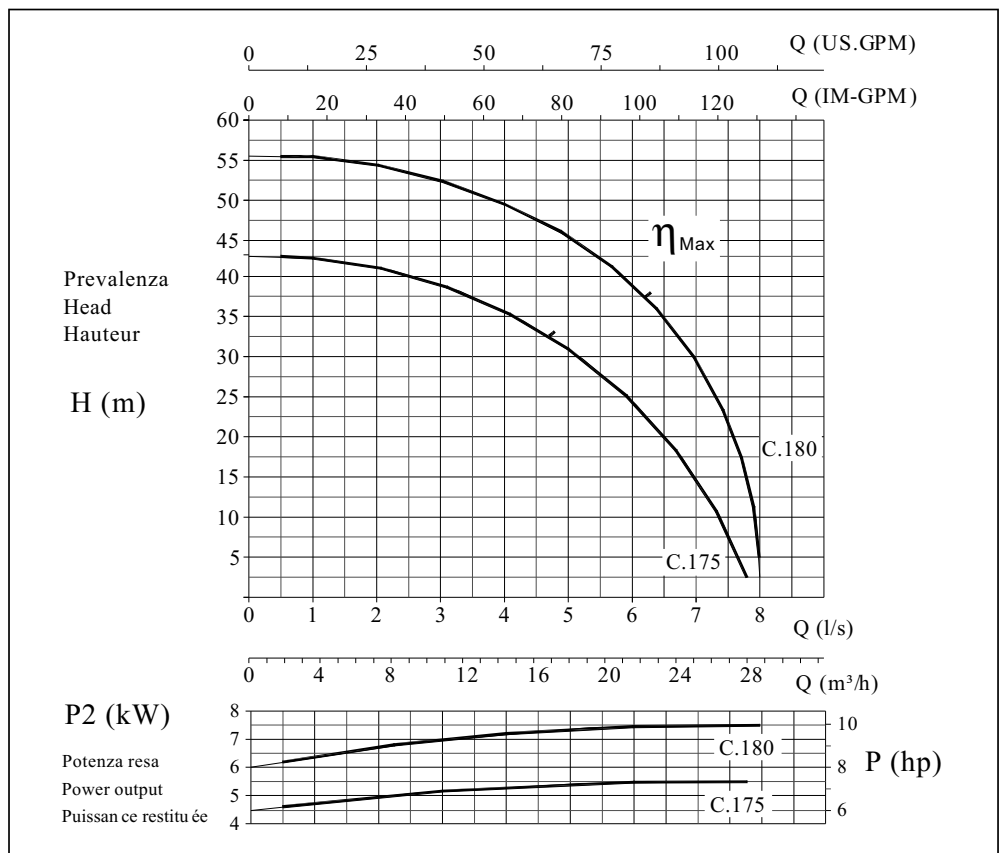

Elettropompa Tipo Electric pump Type Electropompe Type	Prevalenza - Head - Hauteur										
	$\frac{Hm}{bar}$										
	5	10	15	20	25	30	35	40	45	50	55
	Portata - Capacity - Débit										
	Q (l/s)										
GT 65/2/173 C.175	7,8	7,4	7	6,5	5,9	5,3	4	2,5			
GT 65/2/173 C.180	8	7,9	7,75	7,6	7,4	7	6,5	5,8	5	4	1,5

### Dati tecnici / Specifications / Données

	Mandata Delivery Refoulement	kW		r.p.m	Poles	Ampere	Hz	Cos	
		P1	P2	1/min		Trifase 3~ 400V			
GT 65/2/173 C.175	DN2 65	8,2	5,5	2850	2	13,5	50	0,83	
GT 65/2/173 C.180		11	7,5	2850	2	17,5	50	0,87	

### Dimensioni di ingombro

Overall dimensions of packing

Dimensions d'encombrement des emballages

TIPO-TYPE	X	Y	Z	Kg
GT 65/2/173 C.175	350	535	420	85
GT 65/2/173 C.180	350	535	420	86

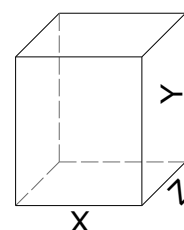

## GT 65/2/173 C. 175-180



INSTALLAZIONE FISSA  
STATIONARY INSTALLATION  
INSTALLATION FIXE

INSTALLAZIONE MOBILE  
MOBILE INSTALLATION  
INSTALLATION PORTABLE

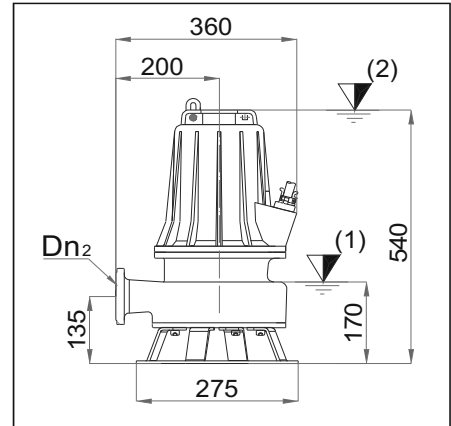
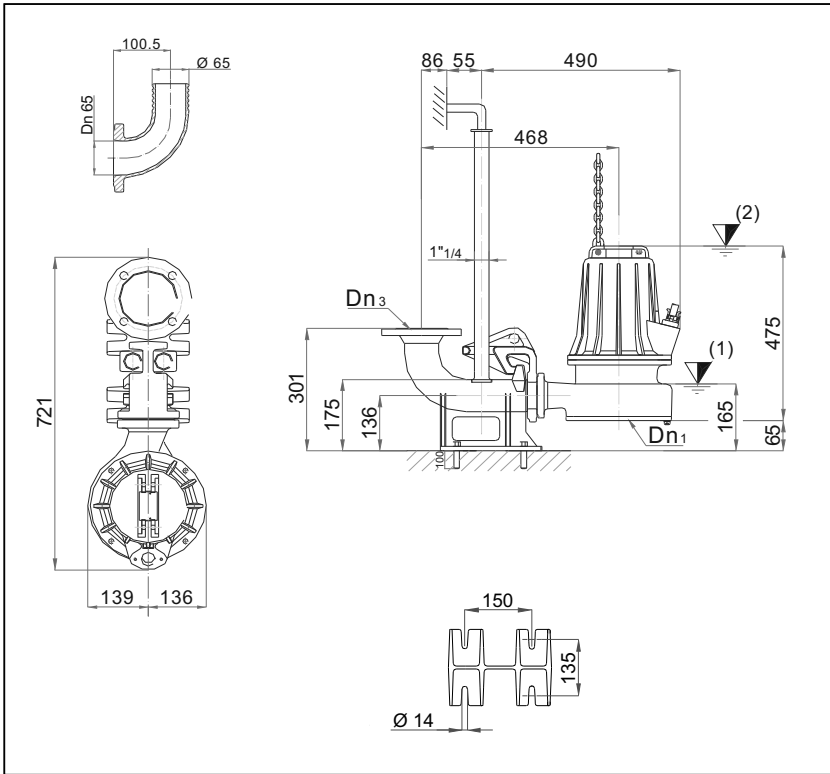

Dimensioni flange UNI  
UNI flange dimensions  
Dimensions brides UNI

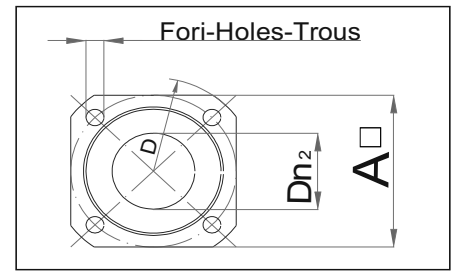

DIMENSIONI FLANGE UNI - UNI FLANGE DIMENSIONS - DIMENSIONS BRIDES UNI

TIPO - TYPE	DN <sub>1</sub>	DN <sub>2/3</sub>	A	B	Fori - Holes - Trous		OPTIONAL			
					n°	mm				
GT 65/2/173 C.175 GT 65/2/173 C.180	65	65	130	160	4	14	P3-DN 65	B4-DN 65	DN 65	

CARATTERISTICHE TECNICHE - TECHNICAL FEATURES - CARACTERISTIQUES TECHNIQUES

TIPO - TYPE	CAVO - CABLE H07 - RNF	MT	Sonde termiche	si				
			Thermal probes	yes				
GT 65/2/173 C.175 GT 65/2/173 C.180	(1) 10x1,5 φ 20 Y-Δ	10	Sondes thermiques	oui	Superiore Upper Supérieur	Inferiore Lower Inférieur	Superiore Upper Supérieur	Inferiore Lower Inférieur
			Sonda di conduttività	si	AR 30	MG1/30/G6	6206 2Z	3206 2Z
			Conductivity probe	yes			32-2-25	
			Sonde de conductivité	oui				

NOTE - NOTES - NOTES :



Punto inferiore d'arresto nel caso di funzionamento automatico  
Lowest shut-off point for automatic operation  
Point d'arrêt le plus bas en service automatique

DRENO POMPE si riserva di modificare senza preavviso i dati riportati in questo catalogo

DRENO POMPE can alter without notifications the data mentioned in this catalogue



Sommergenza minima nel caso di funzionamento continuo  
Minimum covering for continuous operation  
Recouvrement minimal pour service continu

DRENO POMPE se réserve le droit de modifier sans préavis les données techniques dans ce catalogue